

# JAWAR

CHIMNEY

CATALOG 2021



**Chimney systems**  
Ceramic chimneys



made in Poland

# Modern chimneys and ventilation

## SAFETY AND ENERGY SAVING IN CHIMNEY TECHNOLOGY

JAWAR is a manufacturer of chimneys and ventilation systems with 30-year experience. Our products are distinguished by their safety of use and the possibility of effective heat recovery. JAWAR is among the leading chimney manufacturers, constantly introducing innovations, keeping pace with the modern technologies and market needs.

In two production facilities located in central Poland, we manufacture hundreds of kilometers of new chimneys every year. Our product range involves the widest on the Polish market choice of block chimney systems with isostatic ceramics and perlite blocks, ventilation chimneys, as well as stainless steel chimneys and chimney liners. The long experience of the company, connected with innovation, guarantee our customers satisfaction of their purchase.

JAWAR, as one of the few companies in Europe, introduced production of the most modern chimney pipes, manufactured in the technology of isostatic pressing. Chimneys equipped with these pipes are distinguished by easy and fast installation, high resistance to acids, high temperatures and mechanical load.

As the first chimney producer in Europe, JAWAR has introduced chimney and ventilation blocks made of expanded perlite. Using this innovative material in the chimney technology leads to better insulation of chimney, increases the safety of operation and significantly shortens the time of chimney installation.

Our product range is distinguished by the presence of chimney and ventilation systems with heat recovery. We take care of the environment and help our customers save money! This solution is applied to the block chimneys JAWAR NORD, to the stainless steel chimneys JAWAR AERO and ventilation system JAWAR ATMO.

We have our own R&D department. Our team of engineers is constantly working on improving the products and adjusting them to the growing requirements of modern technology. JAWAR, as a socially responsible organization, is investing in solutions that lead to improving the air quality, for the sake of us all.

CEO  
dr Paweł Jarzyński

**Jawar sp z o.o.**

**CIECHANÓW**

ul. Sońska 89  
06-400 Ciechanów



**Perlite Production  
Factory Jawar**

**GLINOJECK**

Zygmuntowo 1c  
06-450 Glinojek



# Isostatic ceramics

JAWAR ceramic pipes are manufactured using the innovative technology of isostatic pressing. They are distinguished by ultimate durability and safety of operation.



Pipe JR	Diameter [cm]	Height [cm]	Tee JT	Diameter [cm]	Height [cm]
	ø 8 ø 12 ø 14 ø 16 ø 18 ø 20	66		ø 8 ø 12 ø 14 ø 16 ø 18 ø 20 ø 25/20	33
	ø 25	33		ø 25	66

\* acceptable dimensional deviation in accordance with EN 1457

## ADVANTAGES OF ISOSTATIC CERAMICS

Properties	traditional technology	Isostatic pressing technology
Resistance to thermal shock	✗	✓
Resistance to soot fire	✓	✓
Low moisture absorption	✗	✓
Resistance to corrosion	✓	✓
Low thermal capacity	✗	✓
Designed to dry and wet flues	✗	✓
High tightness of pipes connection – muff connection	✗	✓
Corrugations on outer surface of pipe – energy saving based on a heat exchanger	✗	✓
Tee (T-Pipe) as uniform single-element (not glued)	✗	✓

### Ceramic cone

**NEW!**

- Corrosion resistant
- Waterproof
- Frost-resistant



## Perlite blocks

Perlite is a volcanic rock of natural origin. It is a very light material so that the weight of chimney blocks is about 20-30% lower than traditional blocks. Perlite is also material twice more thermal insulated than expanded clay, so our chimney systems have a much better heat transfer coefficient than previously used blocks

- Reinforced with polypropylene microfibers
- Easy assembly
- Precise edges - the possibility of joining with glue
- High thermal insulation
- Resistant to high temperatures
- Small weight
- Chemically neutral
- Easy to plaster
- Ecological product, made of natural raw materials
- Two channels perlite block - **NEW**

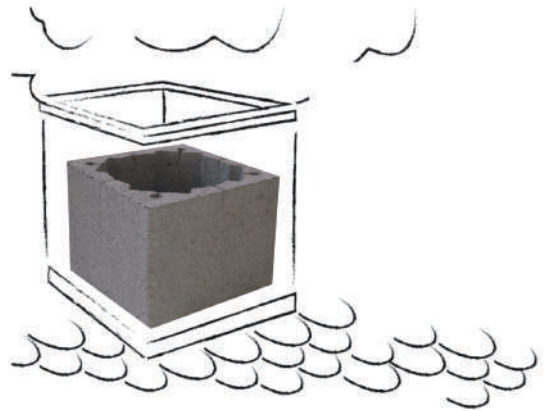

## Cover plates

- system solution
- quick and easy assembly
- frost resistant
- low moisture absorption
- reinforced
- allows further chimney finishing

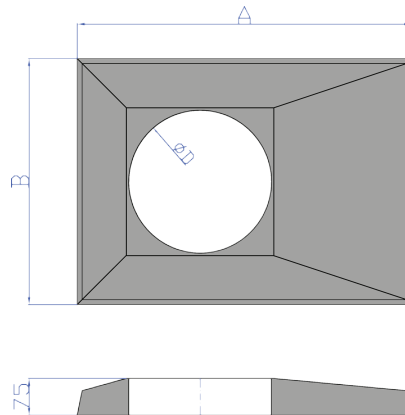

SYMBOL Dimension	CPL2W16	CPL2W 16-20	JPLW8	JPL8	JPLW12	CPL2W16	CPL2W 18-20	JPLW12	CPLW16	CPLW 18-20	JPL2W12
A	680	680	500	380	680	680	680	640	640	640	680
B	500	500	380	340	500	500	500	500	500	500	500
ø D	250	290	140	140	180	250	290	180	250	290	180

# Jawar Uniwersal Plus

Three-layer chimney system designed to exhaust gases from devices run on all types of fuels.

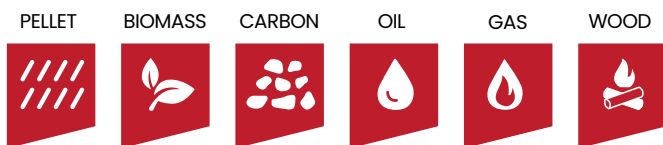

- Designed to exhaust fumes in range of temperatures 60-600°C
- Insulated on full length of chimney
- Isostatic ceramics resistant to corrosion
- Light blocks, made of perlite-concrete
- High tightness of pipes connection - muff connection
- Corrosion and condensate resistance class W3
- Resistant to sootfire
- Chimney system marked with CE according to standards  
EN 13063-1 T600 NI D 3 G50  
EN 13063-2 T400 NI W 3 O00  
EN 13063-3 T600 NI D 3 G50  
EN 13063-3 T400 NI W 3 O00

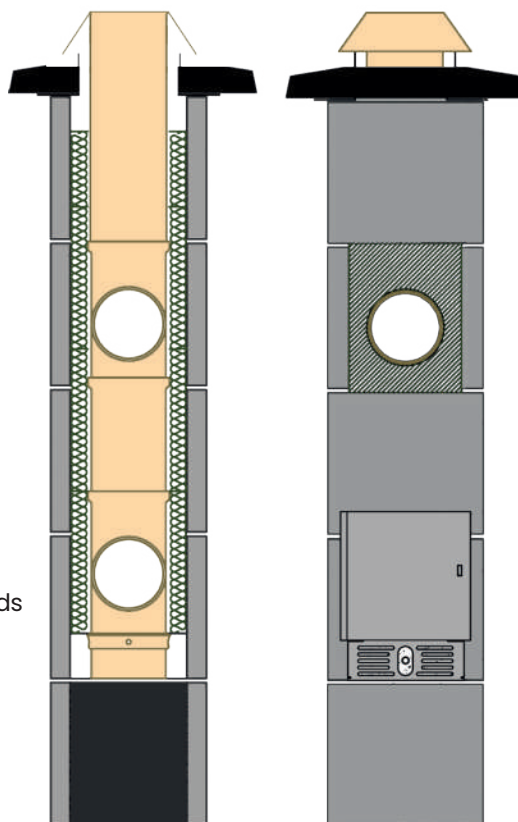

One channel	Diameter [cm]	Measure [cm]	Weight [kg/mb]	With Ventilation	Diameter [cm]	Measure [cm]	Weight [kg/mb]
	ø 16	36x36x33	78		ø 16+W	50x36x33	101
	ø 18	36x36x33	79		ø 18+W	50x36x33	102
	ø 20	36x36x33	79		ø 20+W	50x36x33	102
	ø 25	48x48x33	141		ø 16+2W	54x36x33	118
	16-20	68x36x33	147-150		ø 18+2W	54x36x33	119
					ø 20+2W	54x36x33	119

# Price list Jawar Uniwersal Plus

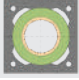
One channel		The total height of the chimney										Additional		
		4mb	5mb	6mb	7mb	8mb	9mb	10mb	11mb	12mb	13mb	+0,33	+0,66	cover plate
∅	measure [ cm ]	EUR	EUR	EUR	EUR	EUR	EUR	EUR	EUR	EUR	EUR	EUR	EUR	EUR
16	36x36x33	305	369	418	483	532	606	655	719	784	848	27	38	25,00
18	36x36x33	312	378	428	494	544	619	669	735	800	866	27	39	25,00
20	36x36x33	321	389	440	507	558	635	686	754	821	889	28	40	25,00
25	48x48x33	571	668	765	863	960	1077	1174	1271	1368	1465	32	65	-

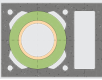
With ventilation		The total height of the chimney										Additional		
		4mb	5mb	6mb	7mb	8mb	9mb	10mb	11mb	12mb	13mb	+0,33	+0,66	cover plate
∅	measure [ cm ]	EUR	EUR	EUR	EUR	EUR	EUR	EUR	EUR	EUR	EUR	EUR	EUR	EUR
16	50x36x33	337	410	467	539	596	678	735	808	880	953	29	43	30,00
18	50x36x33	345	418	476	550	608	692	750	824	897	971	30	44	30,00
20	50x36x33	354	429	488	564	623	708	767	842	918	994	31	45	30,00

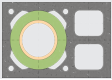
With double ventilation		The total height of the chimney										Additional		
		4mb	5mb	6mb	7mb	8mb	9mb	10mb	11mb	12mb	13mb	+0,33	+0,66	cover plate
∅	measure [ cm ]	EUR	EUR	EUR	EUR	EUR	EUR	EUR	EUR	EUR	EUR	EUR	EUR	EUR
16	54x36x33	358	436	499	576	639	726	789	867	945	1022	31	47	32,00
18	54x36x33	366	445	509	589	651	740	803	882	962	1041	32	48	32,00
20	54x36x33	375	456	520	601	665	756	820	901	982	1063	32	48	32,00

Additional accessories - p. 15

## The price includes:



block

block with ventilation

block with double ventilation

tee 90

inspection unit

Isostatically pressed chimney pipes

insulation

## and installation package:

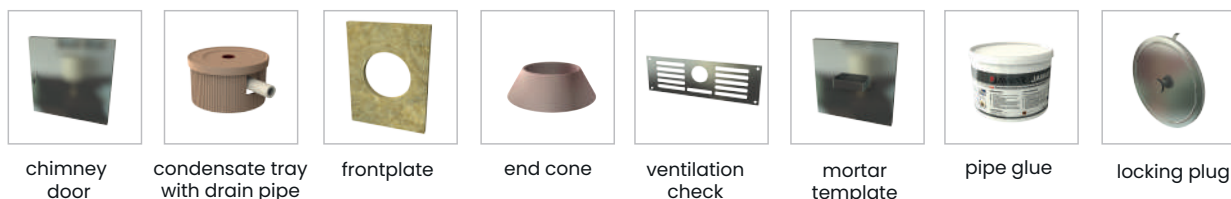

chimney door

condensate tray with drain pipe

frontplate

end cone

ventilation check

mortar template

pipe glue

locking plug

# Jawar Nord

Four-layer chimney system designed to exhaust gases from devices run on solid fuels in energy-efficient construction.

PELLET



WOOD



- Pre- insulated pipes delivered to customer
- First Polish block chimney designed to exhaust gases and supply air to fireplaces
- Does not require any additional air supply from outside of building
- Designed to exhaust gases in range of temperatures 60-600°C
- The only chimney system in Poland, which may be placed next to flammable components (T400 G00)
- Resistant to sootfire
- Chimney system marked with CE according to standards  
EN 13063-1 T600 NI D 3 G50  
EN 13063-1 T400 NI D 3 G00  
EN 13063-3 T600 NI D 3 G50  
EN 13063-3 T400 NI D 3 G00

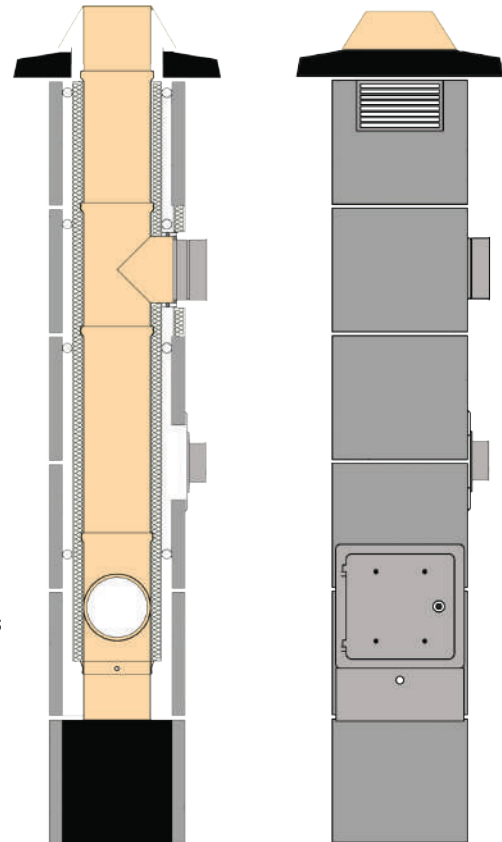

	One channel	Diameter [cm]	Measure [cm]	Weight [kg/mb]	With Ventilation	Diameter [cm]	Measure [cm]	Weight [kg/mb]
		ø 16	36x36x33	76		ø 16+W	50x36x33	99
		ø 18	36x36x33	78		ø 18+W	50x36x33	101
		ø 20	40x40x33	89		ø 20+W	50x36x33	104
						ø 16+2W	54x36x33	117
						ø 18+2W	54x36x33	120





# Price list Jawar Nord

One channel		The total height of the chimney										Additional		
		4mb	5mb	6mb	7mb	8mb	9mb	10mb	11mb	12mb	13mb	+0,33	+0,66	cover plate
∅	measure [ cm ]	EUR	EUR	EUR	EUR	EUR	EUR	EUR	EUR	EUR	EUR	EUR	EUR	EUR
16	36x36x33	475	560	613	698	751	846	899	984	1069	1154	39	46	25,00
18	36x36x33	491	580	634	722	777	875	930	1018	1106	1195	41	48	25,00
20	40x40x33	531	629	691	789	851	959	1021	1119	1217	1315	45	53	29,00

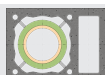
With ventilation		The total height of the chimney										Additional		
		4mb	5mb	6mb	7mb	8mb	9mb	10mb	11mb	12mb	13mb	+0,33	+0,66	cover plate
∅	measure [ cm ]	EUR	EUR	EUR	EUR	EUR	EUR	EUR	EUR	EUR	EUR	EUR	EUR	EUR
16	50x36x33	508	601	662	755	816	919	979	1073	1166	1259	42	51	30,00
18	50x36x33	523	620	682	779	841	948	1010	1107	1203	1300	43	53	30,00
20	54x40x33	561	667	736	842	911	1027	1096	1201	1307	1412	47	58	34,00

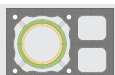
With double ventilation		The total height of the chimney										Additional		
		4mb	5mb	6mb	7mb	8mb	9mb	10mb	11mb	12mb	13mb	+0,33	+0,66	cover plate
∅	measure [ cm ]	EUR	EUR	EUR	EUR	EUR	EUR	EUR	EUR	EUR	EUR	EUR	EUR	EUR
16	54x36x33	529	628	694	792	859	967	1033	1131	1230	1328	44	55	32,00
18	54x36x33	545	647	715	816	884	996	1064	1165	1267	1369	45	57	32,00

The price includes:

Additional accessories - p. 16

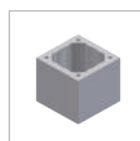

block

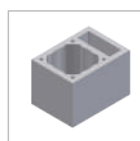

block with ventilation

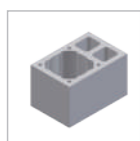

block with double ventilation



tee NORD



inspection unit



Isostatically pressed chimney pipes

and installation package:



bottom cover



chimney door insulated



frontplate



condensate tray with drain pipe



locking plug



end cone



pipe glue

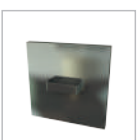

mortar template



air check



bond with rope



air connection

# Jawar K

Double-layer chimney system designed to condensation and low-temperature boilers.

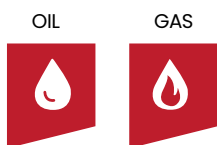

- For condensation and low-temperature boilers
- Designed to gas and oil boilers
- Possibility to work with a boiler with closed combustion chamber
- Maximum exhaust gas temperature 200°C
- Ability to work in overpressure
- For single-family and multifamily houses
- Low weight and dimensions
- Innovative ceramic elbow  $\varnothing 8$ - **NEW!**

- Chimney system marked with CE according to standards

EN 13063-2 T200 NI W 3 O00

EN 13063-2 T200 PI W 3 O00

EN 13063-3 T200 NI W 3 O00

EN 13063-3 T200 PI W 3 O00

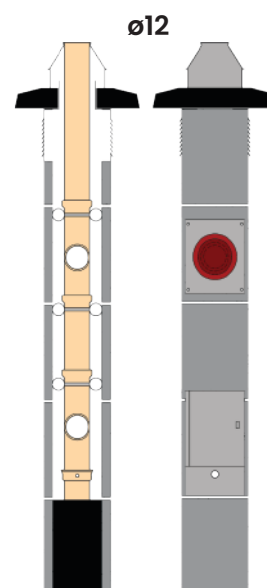
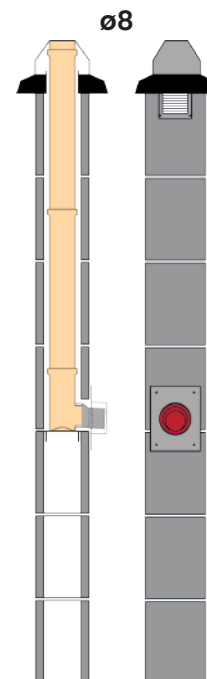
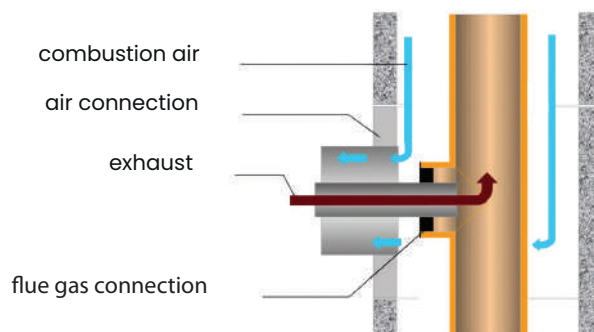

$\varnothing 8$	Diameter [cm]	Measure [cm]	Weight [kg/mb]	$\varnothing 12$	Diameter [cm]	Measure [cm]	Weight [kg/mb]
	$\varnothing 8$	20x24x33	37		$\varnothing 12$	36x36x33	72
	$\varnothing 8+W$	36x24x33	55		$\varnothing 12+W$	50x36x33	95
	$\varnothing 8+2W$	52x24x33	74		$\varnothing 12+2W$	54x36x33	112
	$\varnothing 8+3W$	68x24x33	105				

# Price list Jawar K

ø 8		The total height of the chimney										Additional		
		4mb	5mb	6mb	7mb	8mb	9mb	10mb	11mb	12mb	13mb	+0,33	+0,66	cover plate
ø	measure [ cm ]	EUR	EUR	EUR	EUR	EUR	EUR	EUR	EUR	EUR	EUR	EUR	EUR	EUR
8	20x24x22	274	320	346	392	419	464	491	537	582	628	21	24	21,00
8	36x24x33	306	359	394	447	482	535	570	623	676	730	24	29	26,00
8	52x24x33	337	398	441	502	544	606	648	710	771	832	27	35	-
8	68x24x33	369	438	488	557	607	676	727	796	865	934	29	40	-

ø 8 The price includes:



ø 12		The total height of the chimney										Additional		
		4mb	5mb	6mb	7mb	8mb	9mb	10mb	11mb	12mb	13mb	+0,33	+0,66	cover plate
ø	measure [ cm ]	EUR	EUR	EUR	EUR	EUR	EUR	EUR	EUR	EUR	EUR	EUR	EUR	EUR
12	36x36x33	366	426	467	527	567	627	667	727	787	847	26	33	25,00
12	50x36x33	399	467	515	583	632	700	748	816	884	952	29	39	30,00
12	54x36x33	420	494	547	621	675	748	802	875	948	1022	31	42	32,00

ø 12 The price includes:

Additional accessories - p. 17



# Jawar Kompakt

Ceramic and steel chimney system with a channel for removing fumes from traditional devices and with channel for condensing boilers.

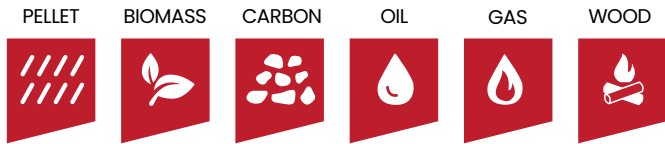

Smoke channel	Gas channel
Temperature range 60-600°C	Temperature range 30-200°C
The ceramic part makes it possible to discharge flue gases from devices for all types of fuels.	The steel part is used to discharge flue gases from gas and oil boilers, condensing as well as Turbo.
Chimney system marked with CE according to standards : EN 13063- 1 T600 NI D 3 G50 EN 13063-2 T400 NI W 3 O00 EN 13063-3 T600 NI D 3 G50 EN 13063-3 T400 NI W 3 O00	Chimney system marked with CE according to standards EN 13063-2 T200 NI W 3 O00 EN 13063-2 T200 PI W 3 O00 EN 13063-3 T200 NI W 3 O00 EN 13063-3 T200 PI W 3 O00
Resistant to soot fire	Possibility of working in over-pressure up to 200 Pa

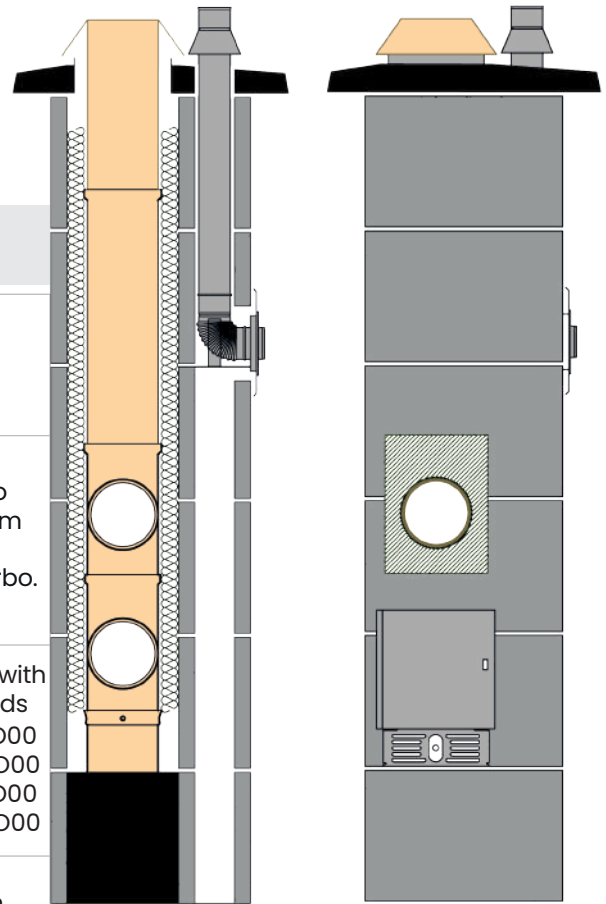

- Allows a wide choice of heating appliances in the boiler room
- Resistant to moisture and condensate
- Small weight and dimensions
- Easy and quick assembly

	Diameter [cm]	Measure [cm]	Weight [kg/mb]
	ø 16+W	54x36x33	120
	ø 18 + W	54x36x33	121
	ø 20 + W	54x36x33	121

# Price list Jawar Kompakt

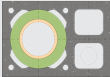
With ventilation		The total height of the chimney										Additional	
		4mb	5mb	6mb	7mb	8mb	9mb	10mb	11mb	12mb	13mb	+0,33	+0,66
∅	measure [ cm ]	EUR	EUR	EUR	EUR	EUR	EUR	EUR	EUR	EUR	EUR	EUR	EUR
16	54x36x33	476	575	656	755	835	944	1025	1124	1220	1319	44	67
18	54x36x33	484	584	665	766	847	958	1039	1140	1237	1338	44	67
20	54x36x33	492	595	677	780	862	974	1056	1159	1258	1360	45	69

Additional accessories - p. 18

## The price includes:

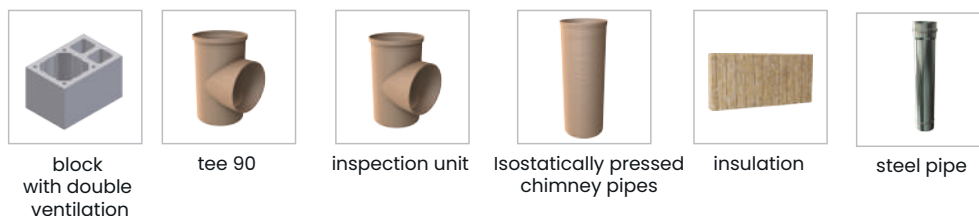

## and installation package:



# Jawar KS

Double-layer steel chimney system designed for condensing and low-temperature boilers

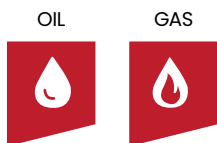

- For gas and oil boilers
- For condensing and low temperature boilers
- Possibility of cooperation with boilers with a closed combustion chamber
- Maximum exhaust temperature 200°C
- Possibility of working in hypertension and underpressure
- Small weight and dimensions
- For use in single-family and multi-family houses
- Chimney system marked CE in accordance with the standard PN-EN 1856-2:2009

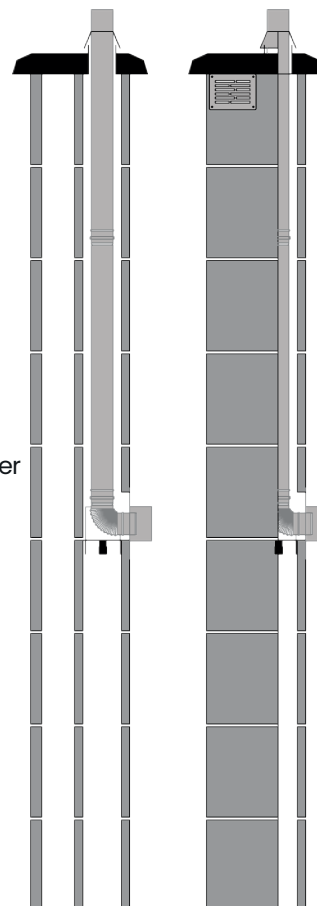

Typ of block		The total height of the chimney										Additional
ø 8		4mb	5mb	6mb	7mb	8mb	9mb	10mb	11mb	12mb	13mb	+0,50
	measure [ cm ]	EUR	EUR	EUR	EUR	EUR	EUR	EUR	EUR	EUR	EUR	EUR
8	20x24x22	154	183	209	238	264	293	319	349	374	404	18,00
8	36x24x33	185	222	256	293	327	364	398	435	469	506	23,00
8	52x24x33	216	261	303	348	390	435	476	521	563	608	29,00
8	68x24x33	248	301	350	403	452	505	555	608	657	710	34,00

The price includes:



block for ø 80

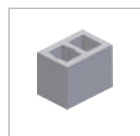

chimney block for ø80 (24x36)

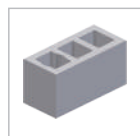

chimney block for ø80 (24x52)

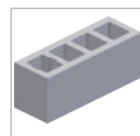

chimney block for ø80 (24x68)



rain flange



air connection

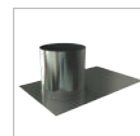

upper chimney plate



stabilizer



steel pipe



condensation elbow with a support



bottom chimney plate

# Ventilation 33cm

Ventilation blocks are intended for construction of natural ventilation ducts. The blocks made of perlite-concrete are extraordinary light, with special insulation properties.

- Fire resistance class EI 120
- High acoustic insulation
- Does not require masonry, easy processing
- Compatible with chimney blocks
- Small size of development, quick and easy installation
- Very good thermal insulation and frost resistance
- Biological resistance prevents the growth of mold and fungi

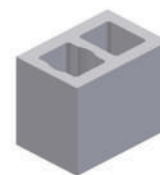

TWO-CHANNEL	
size:	36x24x33cm
weight:	17,25kg
internal channel:	12x16cm



ONE-CHANNEL	
size:	20x24x33cm
weight:	11,25kg
internal channel:	12x16cm

THREE-CHANNEL	
size:	52x24x33cm
weight:	23,70kg
internal channel:	12x16cm

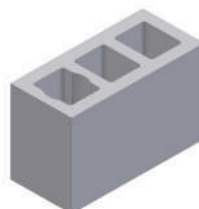

FOUR-CHANNEL	
size:	68x24x33cm
weight:	33,90kg
internal channel:	12x16cm

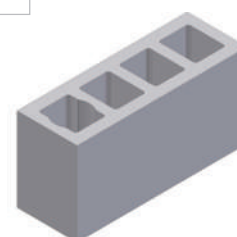

## Price list

		The total height of the chimney									Additional
		1mb	2mb	3mb	4mb	5mb	6mb	7mb	8mb	9mb	± 0,33mb
Typ of blocks	Size [cm]	EUR	EUR	EUR	EUR	EUR	EUR	EUR	EUR	EUR	EUR
one-channel	20x24x33	8	16	24	31	39	47	55	63	71	2,61
two-channel	36x24x33	16	31	47	63	78	94	110	125	141	5,23
three-channel	52x24x33	24	47	71	94	118	141	165	188	212	7,84
four-channel	68x24x33	31	63	94	125	157	188	219	251	282	10,49

## Block mortar

Heat-insulating, lightweight mortar dedicated for chimney and ventilation systems.

- Waterproof
- Frost resistant
- Strong
- Thermally tested
- For indoor and outdoor use

3,60/25kg



Example output:  
chimney size 36x36- 7 mb  
chimney size 36x50- 5 mb

Average output: 20m of joint (width 30mm, height 15mm)

# Accessories Jawar Uniwersal Plus

No.	Index	Name	Unit	Price
1.	JDEKW160	Locking plug 160 insulated	pcs	20,64
2.	JDEKSI160	Locking plug 160 with rope	pcs	24,76
3.	JDEKW180	Locking plug 180 insulated	pcs	21,11
4.	JDEKSI180	Locking plug 180 with rope	pcs	25,23
5.	JDEKW200	Locking plug 200 insulated	pcs	21,61
6.	JDEKS200	Locking plug 200 with rope	pcs	25,86
7.	JDW	Jawar door	pcs	17,73
8.	CKW13x17	Air check13x17	pcs	2,66
9.	JCKW	Ventilation check	pcs	5,09
10.	KLEJ2	Pipe glue 2 kg	pcs	9,71
11.	JODS 140/160	Condensate tray 140/180 (with drain pipe)	pcs	13,71
12.	JODS 180/200	Condensate tray 180/200 (with drain pipe)	pcs	13,71
13.	JODS 250	Condensate tray 250 (with drain pipe)	pcs	28,54
14.	JOLP160	Insulation Uniwersal Plus 160 0,33m	pcs	4,35
15.	JOLP180	Insulation Uniwersal Plus 180 0,33m	pcs	4,50
16.	JOLP200	Insulation Uniwersal Plus 200 0,33m	pcs	4,61
17.	JOL250	Insulation Uniwersal Plus 250 0,33m	pcs	8,14
18.	JPUPP160	Installation Uniwersal Plus 160	pcs	59,52
19.	JPUPP180	Installation Uniwersal Plus 180	pcs	60,71
20.	JPUPP200	Installation Uniwersal Plus 200	pcs	61,90
21.	JPUP250	Installation Uniwersal Plus 250	pcs	121,90
22.	JPCUP	Frontplate 160-200	pcs	2,78
23.	CPC250	Frontplate 250	pcs	10,80

No.	Index	Name	Unit	Price
24.	CPL2W160	Cover plate 160+2W	pcs	32,14
25.	CPL2W180/200	Cover plate 180-200+2W	pcs	32,14
26.	CPL140/160	Cover plate 140-160	pcs	24,76
27.	CPLW140/160	Cover plate 140-160 + W	pcs	30,23
28.	CPL180/200	Cover plate 180-200	pcs	24,76
29.	CPLW180/200	Cover plate 180-200 + W	pcs	30,23
30.	CSZABLON	Mortar template 160-200	pcs	3,64
31.	CSZABLON250	Mortar template 250	pcs	4,38
32.	JSC160	Ceramic cone 160	pcs	23,09
33.	JSC180	Ceramic cone 180	pcs	23,33
34.	JSC200	Ceramic cone 200	pcs	23,57
35.	JR160 0,66	Isostatic pipe Jawar 160 0,66m	pcs	15,28
36.	JR180 0,66	Isostatic pipe Jawar 180 0,66m	pcs	15,73
37.	JR200 0,66	Isostatic pipe Jawar 200 0,66m	pcs	16,42
38.	JR250 0,33	Isostatic pipe Jawar 250 0,33m	pcs	15,21
39.	JT160 90 0,33	Isostatic T-Pipe Jawar 160 90 0,33m	pcs	19,00
40.	JT180 90 0,33	Isostatic T-Pipe Jawar 180 90 0,33m	pcs	20,30
41.	JT200 90 0,33	Isostatic T-Pipe Jawar 200 90 0,33m	pcs	21,76
42.	JT200 45 0,33	Isostatic T-Pipe Jawar 200,45 0,33m	pcs	48,80
43.	JT250 90 0,66	Isostatic T-Pipe Jawar 250,90 0,66m	pcs	68,00
44.	JT250 90 0,33	Isostatic T-Pipe Jawar 250,90 0,33m	pcs	46,14

## Perlite block 33cm

No.	Index	Name	Unit	Price
1.	PPBW	Perlite chimney block 36x36	pcs	6,90
2.	PPBW250	Perlite chimney block 48x48	pcs	9,04
3.	PPBW2C	Perlite chimney block 68x36 (double channel)	pcs	13,80

No.	Index	Name	Unit	Price
4.	PPZW	Perlite chimney block with ventilation 50x36	pcs	9,59
5.	PPZW2W	Perlite chimney block with double ventilation 54x36	pcs	11,38

## Accessories Uniwersal Plus

No.	Index	Name	Unit	Price
1.	JRUP160/180S	Bond with rope 160/180m	pcs	25,47
2.	JRUP180/205S	Bond with rope 180/205m	pcs	25,95
3.	JRUP200/225S	Bond with rope 200/225m	pcs	26,42
4.	JRUP250/280S	Bond with rope 250/280m	pcs	39,52
5.	JDWI	Insulated chimney door	pcs	47,38
6.	JUK	Chimney handle- roof support	pcs	21,19
7.	WDPS160	Rain cap with rope 160	pcs	22,85

No.	Index	Name	Unit	Price
8.	WDPS180	Rain cap with rope 180	pcs	25,23
9.	WDPS200	Rain cap with rope 200	pcs	27,85
10.	JST160	End cone 160	pcs	27,92
11.	JST180	End cone 180	pcs	28,66
12.	JST200	End cone 200	pcs	29,88
13.	JST250	End cone 250	pcs	39,33



## Accessories Jawar Nord

No.	Index	Name	Unit	Price
1.	JDEKW 160	Locking plug 160 insulated	pcs	20,64
2.	JDEKW 180	Locking plug 180 insulated	pcs	21,11
3.	JDEKW 200	Locking plug 200 insulated	pcs	21,61
4.	JDWI	Insulated chimney door	pcs	47,38
5.	JRUP 160/180S	Bond with rope 160/180	pcs	25,47
6.	JRUP 180/205S	Bond with rope 180/205	pcs	25,95
7.	JRUP 200/225S	Bond with rope 250/280m	pcs	26,42
8.	JODS 140/160	Condensate tray 140/160	pcs	13,71
9.	JODS 180/200	Condensate tray 180/200	pcs	13,71
10.	JPMN 160	Installation nord 160	pcs	170,47
11.	JPMN 180	Installation nord 180	pcs	172,14
12.	JPMN 200	Installation nord 200	pcs	174,28
13.	JPCUP	Frontplate 160-200	pcs	2,78
14.	KLEJ2	Pipe glue 2 kg	pcs	9,71
15.	CPL 140/160	Cover plate 140-160	pcs	24,76
16.	CPLW 140/160	Cover plate 140-160+W	pcs	30,23
17.	CPL 180/200	Cover plate 180-200	pcs	24,76
18.	CPLW 180/200	Cover plate 180-200+W	pcs	30,23

No.	Index	Name	Unit	Price
19.	CPL2W 160	Cover plate 160+2W	pcs	32,14
20.	CPL2W 180/200	Cover plate 180-200+2W	pcs	32,14
21.	JNPP	Air connection	pcs	10,47
22.	JRN 160 0,66	Isostatic pipe Nord 160	pcs	32,14
23.	JRN 180 0,66	Isostatic pipe Nord 180	pcs	33,80
24.	JRN 200 0,66	Isostatic pipe Nord 200	pcs	35,71
25.	CSZABLON	Mortar template 160-200	pcs	3,64
26.	JSC 160	Ceramic cone 160	pcs	23,09
27.	JSC 180	Ceramic cone 180	pcs	23,33
28.	JSC 200	Ceramic cone 200	pcs	23,57
29.	JTN200 45 0,33	Isostatic T-Pipe Nord 20 45 0,33m	pcs	62,85
30.	JTN160 90 0,33	Isostatic T-Pipe Nord 16 90 0,33m	pcs	30,71
31.	JTN180 90 0,33	Isostatic T-Pipe Nord 18 90 0,33m	pcs	33,57
32.	JTN200 90 0,33	Isostatic T-Pipe Nord 20 90 0,33m	pcs	36,42
33.	WDPS 160	Rain cap with rope 160	pcs	22,85
34.	WDPS 180	Rain cap with rope 180	pcs	25,23
35.	WDPS 200	Rain cap with rope 200	pcs	27,85
36.	CKWS	Air check SPS	pcs	8,33

### Perlite block 33cm

No.	Index	Name	Unit	Price
1.	PPBW	Perlite chimney block 36x36	pcs	6,90
2.	PPBWN	Perlite chimney block 40x40	pcs	9,04
3.	PPBW2C	Perlite chimney block 68x36 (double channel)	pcs	13,80

No.	Index	Name	Unit	Price
4.	PPZWN	Perlite chimney block with ventilation 50x40	pcs	11,31
5.	PPZ2W	Perlite chimney block with double ventilation 54x36	pcs	11,38
6.	PPZW	Perlite chimney block with ventilation 50x36	pcs	9,59

## Accessories Jawar K

No.	Index	Name	Unit	Price
1.	JDEK 8	Locking plug 8	pcs	22,26
2.	JDEK 120	Locking plug 12	pcs	23,33
3.	JDWK	Insulated chimney door Jawar K	pcs	21,19
4.	JKP	Bottom cover	pcs	6,66
5.	JM 80	Gas membrane 80/60	pcs	6,66
6.	JM 100	Gas membrane 100/80	pcs	9,52
7.	JM 120	Gas membrane 120/100	pcs	10,59
8.	JCO 80	Stabiliser 80	pcs	6,19
9.	JCO 120	Stabiliser 120	pcs	6,43
10.	JOD 80	Condensate tray 80	pcs	11,90
11.	JOD 120	Condensate tray 120	pcs	13,45
12.	JPMJK 80	Installation Jawar K 80	pcs	140,95
13.	JPMJKK 80	Installation Jawar K 80	pcs	148,33
14.	JPMJK 120	Installation Jawar K 120	pcs	149,29
15.	JPPK	Air connection Jawar K	pcs	24,29
16.	JPL 8	Cover plate 80	pcs	21,49
17.	JPLW 8	Cover plate 80+W	pcs	26,19
18.	JPL 12	Cover plate 120	pcs	24,28
19.	JPLW 12	Cover plate 120+W	pcs	29,52
20.	JPL2W 12	Cover plate 120+2W	pcs	31,43
21.	JST 80	End cone 80	pcs	22,74
22.	JST120	End cone 120	pcs	24,08
23.	JSZK	Mortar template Jawar K	pcs	2,62

No.	Index	Name	Unit	Price
24.	JAK080	adapter Jawar K 80	pcs	20,31
25.	JPPK080KO	Air connection Jawar K 80	pcs	24,29
26.	JKRZ080/098	Reducer Jawar K 80	pcs	26,00
27.	JK80 95 0,25	Isostatic elbow 80 95 0,25	pcs	37,86
28.	JR80 0,66	Isostatic pipe 80 0,66m	pcs	12,66
29.	JR120 0,66	Isostatic pipe 120 0,66m	pcs	13,19
30.	JSK	Silicone Jawar K 310ml	pcs	6,19
31.	JT 80 90 0,33	Isostatic T-Pipe 80 90 0,33m	pcs	16,78
32.	JT 120 90 0,33	Isostatic T-Pipe 120 90 0,33m	pcs	18,10
33.	WBKD	Bottom chimney plate	pcs	7,50
34.	WBKG	Upper chimney plate	pcs	10,00
35.	JW80	Tool for smoothing joints 80	pcs	3,33
36.	JW120	Tool for smoothing joints 120	pcs	3,57
37.	PPIW	Chimney block for ø80 (20x24)	pcs	2,61
38.	PP2W	Chimney block for ø80 (36x24)	pcs	5,23
39.	PP3W	Chimney block for ø80 (52x24)	pcs	7,85
40.	PP4W	Chimney block for ø80 (68x24)	pcs	10,47
41.	PPBW	Chimney block for ø120 (36x36)	pcs	6,90
42.	PPZW	Chimney block for ø120 (50x36)	pcs	9,59
43.	PPZ2W	Chimney block for ø120 (54x36)	pcs	11,38
44.	JPW8	Support plate Jawar K 80	pcs	32,14
45.	CPW	Support plate (Jawar K 120)	pcs	37,14
46.	CKW13x17	Air check 13x17	pcs	2,66

## Accessories Jawar Kompakt

No.	Index	Name	Unit	Price
1.	JDEKW160	Locking plug 160 insulated	pcs	20,64
2.	JDEKS160	Locking plug 160 with rope	pcs	24,76
3.	JDEKW180	Locking plug 180 insulated	pcs	21,11
4.	JDEKS180	Locking plug 180 with rope	pcs	25,23
5.	JDEKW200	Locking plug 200 insulated	pcs	21,61
6.	JDEKS200	Locking plug 200 with rope	pcs	25,85
7.	JDW	Jawar door	pcs	17,73
8.	CKW 13x17	Air check 13x17	pcs	2,66
9.	JCKW	Ventilation check	pcs	5,09
10.	KLEJ2	Pipe glue 2 kg	pcs	9,71
11.	JODS 140/160	Condensate tray 140/160	pcs	13,71
12.	JODS 180/200	Condensate tray 180/200	pcs	13,71
13.	JOLP 160	Insulation Uniwersal Plus 160 0,33m	pcs	4,35
14.	JOLP 180	Insulation Uniwersal Plus 180 0,33m	pcs	4,50
15.	JOLP 200	Insulation Uniwersal Plus 200 0,33m	pcs	4,61
16.	JPUPP 160	Installation Uniwersal Plus 160	pcs	59,52
17.	JPUPP 180	Installation Uniwersal Plus 180	pcs	60,71
18.	JPUPP 200	Installation Uniwersal Plus 200	pcs	61,90
19.	JPMK	Installation Jawar Kompakt	pcs	86,30
20.	JPCUP	Frontplate 160-200	pcs	2,78
21.	JSC 160	Ceramic cone 160	pcs	23,09

No.	Index	Name	Unit	Price
22.	JSC 180	Ceramic cone 180	pcs	23,33
23.	JSC 200	Ceramic cone 200	pcs	23,57
24.	JR 160 0,66	Isostatic pipe Jawar 160 0,66m	pcs	15,28
25.	JR 180 0,66	Isostatic pipe Jawar 180 0,66m	pcs	15,73
26.	JR 200 0,66	Isostatic pipe Jawar 200 0,66m	pcs	16,42
27.	JT 160 90 0,33	Isostatic T-Pipe Jawar 160 90 0,33m	pcs	19,00
28.	JT 180 90 0,33	Isostatic T-Pipe Jawar 180 90 0,33m	pcs	20,30
29.	JT 200 90 0,33	Isostatic T-Pipe Jawar 200 90 0,33m	pcs	21,76
30.	JT 200 45 0,33	Isostatic T-Pipe Jawar 200 45 0,33m	pcs	48,80
31.	CSZABLON	Mortar template 160-20	pcs	3,64
32.	KR080 0,50	Steel pipe 0,80 0,50m	pcs	12,73
33.	KR080 1,00	Steel pipe 0,80 1,00m	pcs	17,85
34.	WBKG080	Upper chimney sheet 80mm	pcs	10,00
35.	WS080	Stabiliser 080	pcs	3,76
36.	JPPK	Air connection Jawar K	pcs	24,28
37.	WBKD	Bottom chimney sheet	pcs	7,50
38.	WEZYK2M	Hose line 2m	pcs	2,54
39.	KK080 90 PODP	Condensation elbow with a support 80/90	pcs	34,52
40.	JDWK	Insulated chimney door Jawar K	pcs	21,19
41.	PPZ2W	Chimney block 54x36	pcs	11,38
42.	IKPK080	Rain falange	pcs	10,00

## Accessories Jawar KS

No.	Index	Name	Unit	Price
1.	PP1W	Chimney block for ø80 (20x24)	pcs	2,61
2.	PP2W	Chimney block for ø80 (36x24)	pcs	5,23
3.	PP3W	Chimney block for ø80 (52x24)	pcs	7,85
4.	PP4W	Chimney block for ø80 (68x24)	pcs	10,47
5.	KR0 80 1,00	Steel pipe 080 1,00m	pcs	17,85
6.	KR 080 0,50	Steel pipe 080 0,50m	pcs	12,73
7.	KTW080	T-pipe with inspection unit 080	pcs	22,61
8.	KK080 90 PODP	Condensation elbow with support 90/80mm	pcs	34,52

No.	Index	Name	Unit	Price
9.	WBKG080	Upper chimney sheet 80mm	pcs	10,00
10.	WS080	Stabiliser 080	pcs	3,76
11.	CKW13x17	Air check 13x17	pcs	2,66
12.	JPPK	Air connection Jawar K	pcs	24,28
13.	WBKD	Bottom chimney sheet (80-100mm)	pcs	7,50
14.	WEZYK2M	Hose line 2m	pcs	2,50
15.	JDWK	Insulated chimney door Jawar K	pcs	21,19
16.	IKPK 080	Rain falange	pcs	10,00

# Jawar Cerastal

Ceramic-steel chimney system designed to exhaust gases from all types of heating devices.

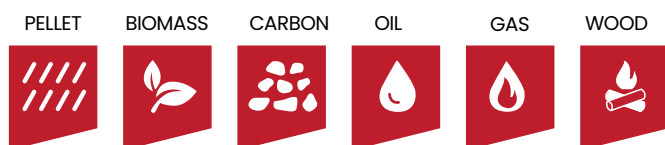

- Designed to exhaust gases in range of temperatures 60-600°C
- Insulated on full length of chimney
- Resistant to corrosion isostatic ceramics - high resistance to condensate, possible to use with coal and pellets
- Low weight of the chimney - possible to build on wall supports - without foundation
- Easy and fast installation
- ø 12, 16, 18, 20, 25
- Chimney system marked with CE according to standards  
EN 13063-1 T600 NI D 3 G50  
EN 13063-2 T 400 NI W 3 O00

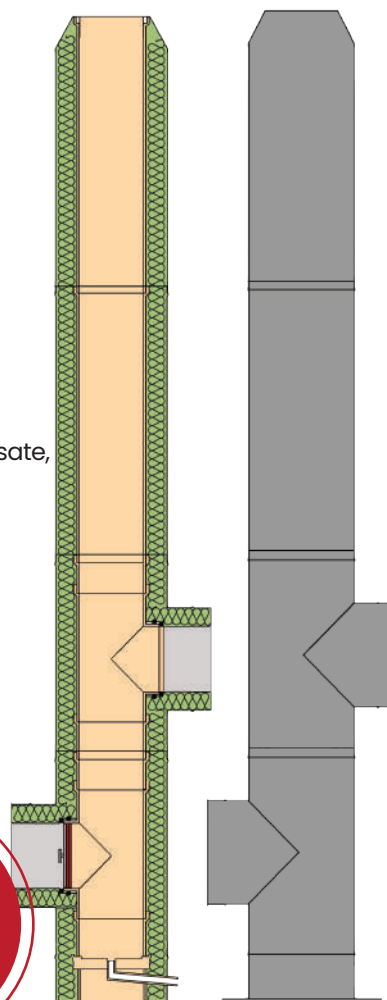

The total height of the chimney

dimensions [cm]	4,90	5,54	6,18	6,82	7,46	8,10	8,74	9,38	10,02	10,66	11,30	11,94
	EUR	EUR	EUR	EUR	EUR	EUR	EUR	EUR	EUR	EUR	EUR	PLN
12	700	765	850	934	998	1083	1157	1241	1305	1390	1454	1539
14	755	825	915	1006	1075	1166	1245	1336	1405	1496	1566	1656
16	826	902	1001	1101	1177	1276	1362	1461	1537	1637	1713	1812
18	902	986	1095	1205	1289	1399	1493	1602	1686	1796	1880	1990
20	976	1068	1185	1302	1394	1511	1612	1730	1821	1938	2030	2147
25	* individual pricing											

The price includes:



pipe



tee



inspection pipe



mouth ending



condensate tray



strengthened wall spacer



band clip strengthened



locking bar strengthened

# Accessories Jawar Cerastal

No.	INDEX	Name	120/250mm	140/250mm	160/280mm	180/300mm	200/325mm	250/400mm
1.	CER	Pipe 0,66	51,66	57,38	61,66	66,43	68,10	79,29
2.	CET	T-Pipe 90 0,50m	74,52	87,14	91,43	98,57	107,86	
3.	CET250	T-Pipe 90 0,66m						125,95
4.	CEW	Inspection pipe 0,50m	87,14	94,76	104,05	111,19	120,71	
5.	CEW250	Inspection pipe 0,66m						140,71
6.	CEO B	Condensate tray with side pipe	38,33	41,66	44,52	47,14	49,76	56,19
7.	CEO	Condensate tray with side pipe	38,33	41,66	44,52	47,14	49,76	56,19
8.	CEU	Mouth ending 0,66	66,43	71,19	79,52	82,86	87,86	109,52
9.	IOZWN	Band clip strenghtened	12,38	12,38	14,52	18,10	23,57	30,95
10.	IOW	Band clip strenghtened h= 200	38,33	36,33	40,71	44,05	44,29	45,48
11.	IOSW	Strenghtened wall spacer	20,71	20,71	23,10	24,76	25,48	27,86
12.	IWSO 50-125	Wall spacer brackets 50-125mm	12,38					
13.	IWSO 125-200	Wall spacer brackets 125-200mm	15,00					
14.	IWSO 200-275	Wall spacer brackets 200-275mm	17,86					
15.	IWSO 275-350	Wall spacer brackets 275,350mm	20,71					
16.	IKPN	Rain flange	14,05	14,05	15,71	20,24	20,95	25,48
17.	IEND	End cap	23,33	24,29	25,48	27,17	28,33	35,57
18.	IPD 0-5	Roof duct 0-5	53,81	53,81	58,57	60,95	63,81	72,86
19.	IPD 5-20	Roof duct 5-20	58,57	58,57	66,19	70,71	77,86	76,90
20.	IPD 20-35	Roof duct 20-35	67,62	67,62	67,62	74,76	88,57	85,00
21.	IPD 35-50	Roof duct 35-50	84,52	84,52	86,66	88,57	92,14	110,00
22.	KLEJ2	Pipe glue 2 kg	9,52					
23.	IWSP II	Base plate II brackets	15,24					
24.	IWSP III	Base plate III brackets	22,86					
25.	IWSP IV	Base plate IV brackets	32,62					
26.	IWSP V	Base plate V brackets	51,66					

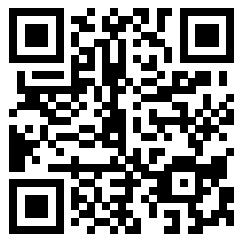

Jawar Sp. z o.o  
Sońska 89  
06-400 Ciechanów, Poland  
+48 (023) 672 24 16, 673 54 00  
E-mail: [handel@jawar.com.pl](mailto:handel@jawar.com.pl)  
[www.jawar.com.pl](http://www.jawar.com.pl)

Perlite Production Factory Jawar  
Zygmuntowo 1c  
06-450 Głinojeck  
Poland